

AERODROME GROUND
MOVEMENT CHART - ICAO

APRON ELEV 6 m

TWR	118.2(E)	118.8(W)
GND	121.75(E)	121.7(W)
APRON	121.65	122.175
	121.8	123.325

SEOUL / Incheon Intl
RWY 15L/R, 33L/R DEPARTURE

ELEVATIONS AND DIMENSION IN METERS
BEARINGS ARE MAGNETIC



ANNUAL RATE OF CHANGE
6' W

LEGEND	
WNG 112.9	VOR CHECK-POINT AND FREQUENCY
• • •	Stop-bar light
54R	Holding position
R4	Taxi lane
50	Gate
301	Remote stand
→	Taxi routes
→	De-icing pad taxi routes
3	Powered taxi-start point
1E	Transfer of control point(TCP)
Open Channel	
Hot Spot	
ATC service boundary (Maneuvering Area)	
RPBB (Remote Passenger Boarding Bridge)	

Note
All aeroplane will taxi at speeds of more than 10 kt on
Taxiways A, B, C, D, M, N or P to ensure smooth traffic flow
unless there is exceptional direction concerning safety factors by ATC.
And if it is impracticable, pilots shall notify to ATC.



HS 1	AIRCRAFT TAXIING ON TAXIWAY J FROM RUNWAY 15L AFTER LANDING USE CAUTION WHEN ATC UTILIZES RUNWAY 15R FOR TAKEOFFS. DO NOT CROSS THE HOLDING MARKING FOR RUNWAY 15R WITHOUT ATC AUTHORIZATION.
HS 2	AIRCRAFT TAXIING ON TAXIWAY K FROM RUNWAY 33R AFTER LANDING USE CAUTION WHEN ATC UTILIZES RUNWAY 33L FOR TAKEOFFS. DO NOT CROSS THE HOLDING MARKING FOR RUNWAY 33L WITHOUT ATC AUTHORIZATION.
HS 21 ~ 24, 29	USE CAUTION OF CONFUSION ON TAXIWAYS. DO NOT PROCEED TAXIING BEYOND TRANSFER OF CONTROL POINTS WITHOUT CLEARANCE FROM INCHEON APRON OR GROUND(TOWER).
HS 25 ~ 28	USE CAUTION OF CONFUSION ON TAXIWAYS.

Note 1
When non-standard taxi routes are applicable,
Incheon APRON will issue transition taxi instructions one to
another taxilane in APRON 2, APRON 3, APRON 4 and
Cargo APRONS.

Note 2
Aircraft shall not taxi into maneuvering area without clearance
from Incheon Tower or Ground.

		SURFACE	WIDTH	STRENGTH
APRON	Apron 1, 2 Cargo Apron 1 Maintenance Apron	Concrete	-	PCN 86/R/B/X/T
	Apron 3, 4 Cargo Apron 2			PCN 85/R/B/X/T
TWY A, D		Concrete	30 m Shoulder : 15 m - Paved : 12 m - Turfed : 3 m	PCN 86/R/B/X/T
TWY B, C		Asphalt		PCN 88/F/B/X/T
TWY M		Concrete	30 m Shoulder : 15 m - Paved : 15 m	PCN 85/R/B/X/T
TWY N		Asphalt		PCN 75/F/B/X/T
TWY P		Asphalt		PCN 75/F/B/X/T

Taxiway edge lights on all taxiways curve area
Taxiway center line lights on all taxiways
PAX Terminal and Concourse A VDGS equipped

Change : Information of TCP(3T and 4T).

AERODROME GROUND
MOVEMENT CHART - ICAO

APRON ELEV 6 m

TWR	118.2(E)	118.8(W)
GND	121.75(E)	121.7(W)
APRON	121.65	122.175
	123.675	121.8
		123.325

RKSI AD CHART 2 - 7
9 MAR 2023
SEOUL / Incheon Intl
RWY 15L/R, 33L/R ARRIVAL

ELEVATIONS AND DIMENSION IN METERS
BEARINGS ARE MAGNETIC



ANNUAL RATE OF CHANGE
6' W

HS 1	AIRCRAFT TAXIING ON TAXIWAY J FROM RUNWAY 15L AFTER LANDING USE CAUTION WHEN ATC UTILIZES RUNWAY 15R FOR TAKEOFFS. DO NOT CROSS THE HOLDING MARKING FOR RUNWAY 15R WITHOUT ATC AUTHORIZATION.
HS 2	AIRCRAFT TAXIING ON TAXIWAY K FROM RUNWAY 33R AFTER LANDING USE CAUTION WHEN ATC UTILIZES RUNWAY 33L FOR TAKEOFFS. DO NOT CROSS THE HOLDING MARKING FOR RUNWAY 33L WITHOUT ATC AUTHORIZATION.
HS 21~24, 29	USE CAUTION OF CONFUSION ON TAXIWAYS. DO NOT PROCEED TAXIING BEYOND TRANSFER OF CONTROL POINTS WITHOUT CLEARANCE FROM INCHEON APRON OR GROUND(TOWER).
HS 25~28	USE CAUTION OF CONFUSION ON TAXIWAYS.

Note 1
All aeroplane will taxi at speeds of more than 10 kt on Taxiways A, B, C, D, M, N or P to ensure smooth traffic flow unless there is exceptional direction concerning safety factors by ATC. And if it is impracticable, pilots shall notify to ATC.

Note 2
When non-standard taxi routes are applicable, Incheon APRON will issue transition taxi instructions one to another taxilane in APRON 2, APRON 3, APRON 4 and Cargo APRONS.

CAUTION
For Gate 11 and 42, pilots needs to pay extra caution to follow the lead lines, which may require more than two turns.

		SURFACE	WIDTH	STRENGTH
APRON	Apron 1, 2 Cargo Apron 1 Maintenance Apron	Concrete	-	PCN 86/R/B/X/T
	Apron 3, 4 Cargo Apron 2	Concrete		PCN 85/R/B/X/T
	TWY A, D	Concrete	30 m Shoulder : 1.5 m - Paved : 1.2 m - Turfed : 3 m	PCN 86/R/B/X/T
	TWY B, C	Asphalt		PCN 88/F/B/X/T
	TWY M	Concrete	30 m Shoulder : 1.5 m - Paved : 1.5 m	PCN 85/R/B/X/T
	TWY N	Asphalt		PCN 75/F/B/X/T
	TWY P	Asphalt		PCN 75/F/B/X/T

Taxiway edge lights on all taxiways curve area
Taxiway center line lights on all taxiways
PAX Terminal and Concourse A VDGS equipped

LEGEND	
WNG 112.9	VOR CHECK-POINT AND FREQUENCY
• • •	Stop-bar light
(S4R)	Holding position
R4	Taxi lane
(50)	Gate
301	Remote stand
→	Taxi routes
→	Alternate Taxi routes
TE	Transfer of control point(TCP)
—	Open Channel
○	Hot Spot
□	ATC service boundary (Maneuvering Area)
RPBB	RPBB (Remote Passenger Boarding Bridge)



Change : Information of TCP(3T and 4T).

OFFICE OF CIVIL AVIATION

AIRAC AIP AMDT 3/23
Effective : 1600UTC 19 APR 2023

AERODROME GROUND
MOVEMENT CHART - ICAO

APRON ELEV 6 m

TWR 118.2(E) 118.8(W)
GND 121.75(E) 121.7(W)
APRON 121.65 122.175 123.675
121.8 123.325

SEOUL / Incheon Intl
RWY 16L/R, 34L/R DEPARTURE

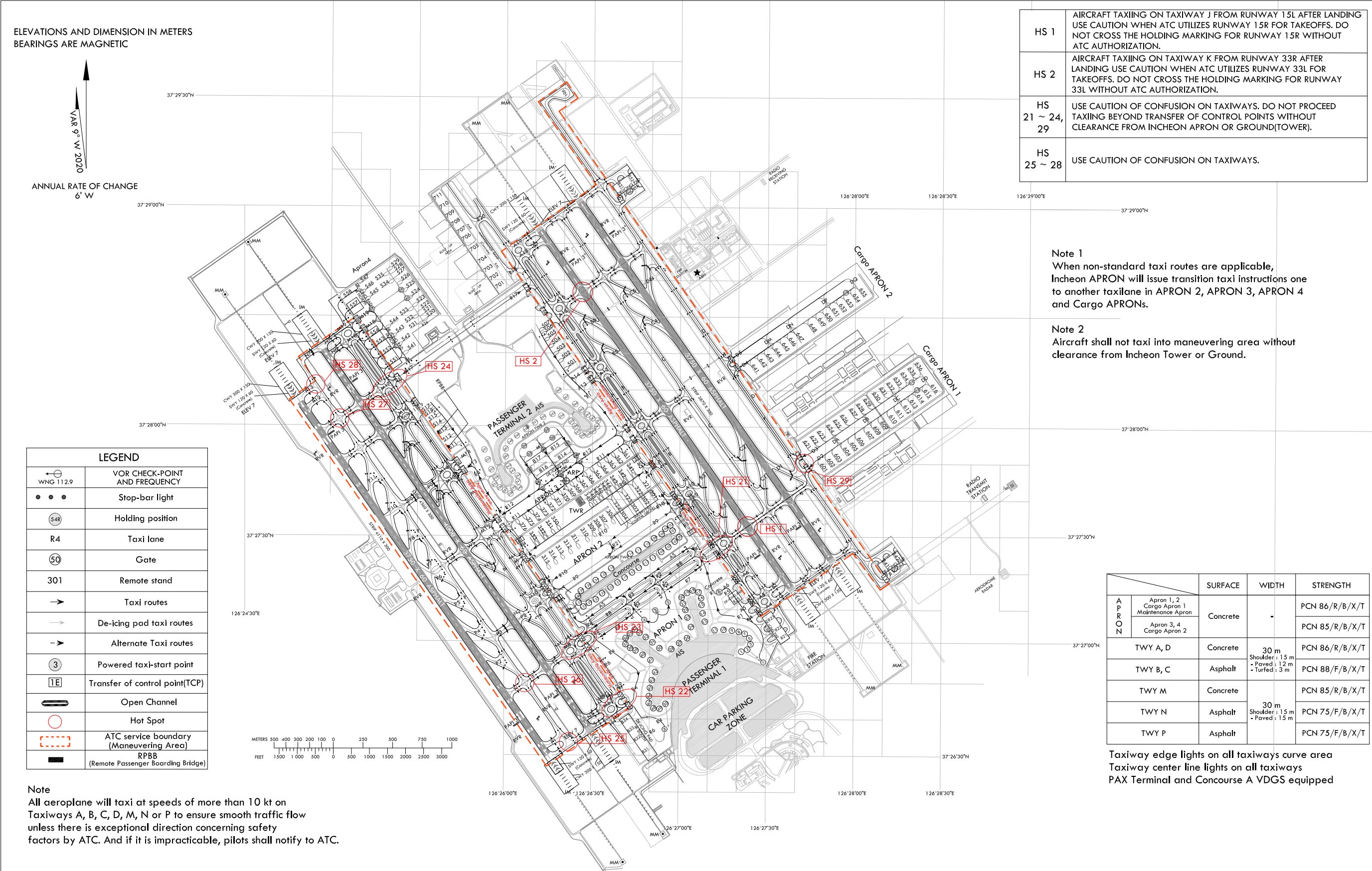

Change : Information of TCP(3T and 4T).

AERODROME GROUND
MOVEMENT CHART - ICAO

APRON ELEV 6 m

TWR 118.2(E) 118.8(W)
GND 121.75(E) 121.7(W)
APRON 121.65 122.175 123.675
121.8 123.325

RKSI AD CHART 2 - 9
9 MAR 2023
SEOUL / Incheon Intl
RWY 16L/R, 34L/R ARRIVAL

